

HAPP CONTROLS

Installation Instructions for Optic Gun Hose Clamp Kit for Both Metal and Rubber Hose Part Number 96-0290-00

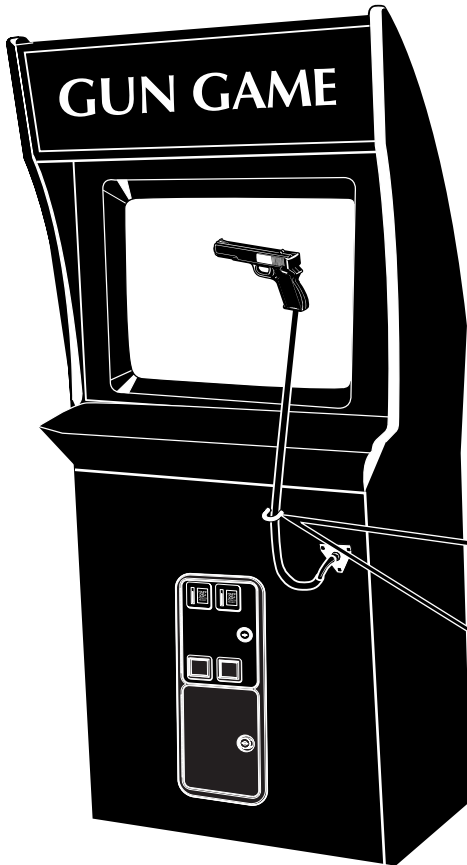

Kit consists of:

Qty.	Description	Part Number	Ref.
1	Gun Hose Clamp	50-3002-00	A
4	1/4" Flat Washer	43-0215-00	B
2	1/4" Nut - 20 Nylock	43-0121-00	C
1	Clip for metal hose	95-1416-00	-
1	Tether cord	95-1361-00	-
1	Screw 6-32 X 3/8	42-0314-00	-
1	Nut Nylock 6-32 hex	43-0375-00	-

Assembly Diagram for Rubber Hose

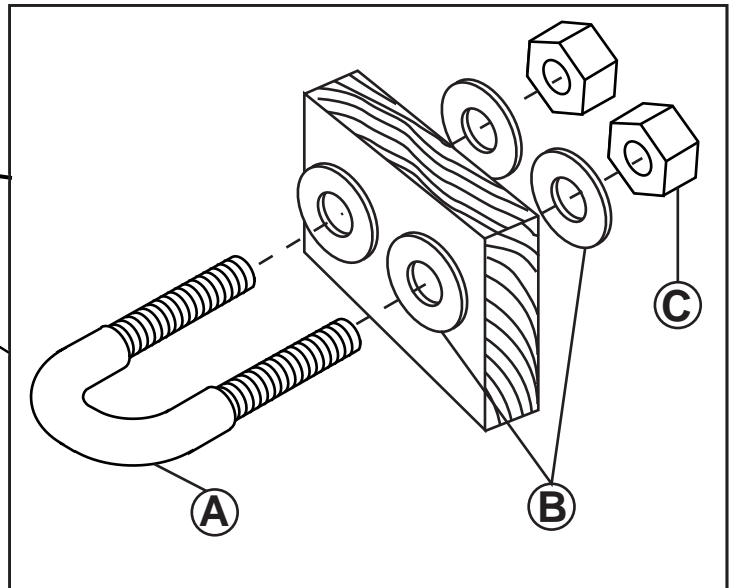

INSTRUCTIONS FOR RUBBER HOSE

1. Hold the optic gun hose against the cabinet allowing the gun end to dangle at a desired distance from the floor.
2. Locate the bend in the hose and mark the cabinet just prior to this bend. Note: Make sure hose is vertical when marking.
3. Mark .40" out from the center of the hose on both sides. This mark should be perpendicular from the mark made in step #2.
4. Place threaded part of hose clamp(A) on marks made in steps #2 & #3 to see if the dimension between the two threaded rods are correct.
5. Drill two 1/4" holes through cabinet where the marks from steps #2 & #3 are located (using the drilling template).
6. Place two of the supplied washers(B) on the hose clamp(A).
7. Captivate the hose within the inner diameter of the hose clamp(A).
8. Place clamp, hose and washer assembly into 1/4" drilled holes.
9. Insert the remaining two washers(B) and nuts(C) and on the inside portion of the clamp and tighten securely to cabinet.
10. Remaining parts utilized for metal hose design.

DRILLING TEMPLATE

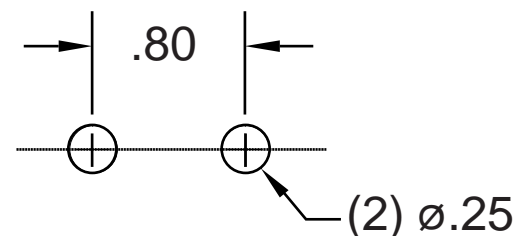

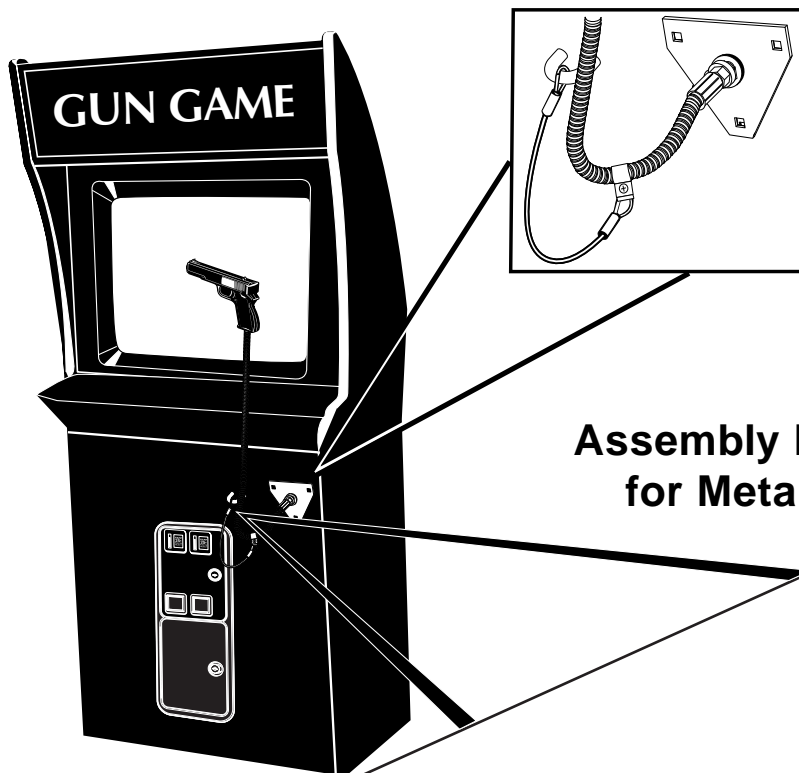

Kit consists of:

Qty.	Description	Part Number	Ref.
1	Gun Hose Clamp	50-3002-00	A
4	1/4" Flat Washer	43-0215-00	B
2	1/4" Nut - 20 Nylock	43-0121-00	C
1	Clip for metal hose	95-1416-00	D
1	Tether cord	95-1361-00	E
1	Screw 6-32 X 3/8	42-0314-00	F
1	Nut Nylock 6-32 hex	43-0375-00	G
1	#6 File washer	43-0004-00	H

Assembly Diagram for Metal Hose

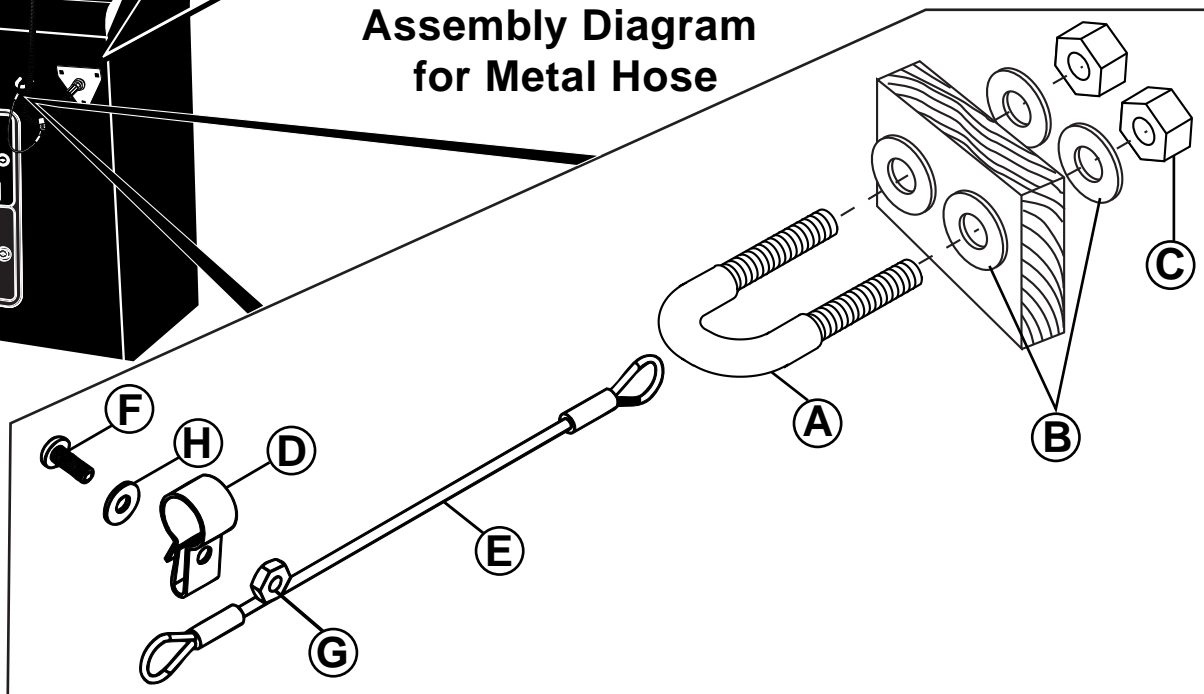

INSTRUCTIONS FOR METAL HOSE

1. Locate an area within the front vertical surface of the cabinet to install the gun hose clamp(A). This area selected should be at least the height of the where the hose anchor plate is installed within the cabinet.
2. Using the supplied drilling template, drill two 1/4" holes thru cabinet.
3. Slide end of tether cord(E) thru one side of gun hose clamp(A).
4. Place two of the supplied washers(B) on the hose clamp(A).
5. Place clamp with tether cord and washer assembly into 1/4" drilled holes.
6. Insert the remaining two washers(B) and nuts(C) on the inside portion of the clamp and tighten securely to cabinet.
7. Hold the metal optic gun hose against the cabinet allowing the gun end to dangle at a desired distance from the floor.
8. Locate the bend in the hose and mark the metal hose just prior to this bend. Note: make sure hose is vertical when marking.
9. Slide the small end of the clip for metal hose(D) on the open end of the tether cord(E).
10. Open the clip for metal hose(D) just enough to fit the hose in.
11. Using a pliers, squeeze the clip closed and insert Screw(F) and Washer(H) and tighten Nut(G).
12. Drop gun and confirm that it will not hit the floor.

