

ERP CODE	-	1	2	3	4	5	6	7	8	9	10
REV.	DATE	ECO NO	DESCRIPTION OF CHANGE					DRAWN	APPROVAL		
0	070329		INITIAL DRAWING					S.J			

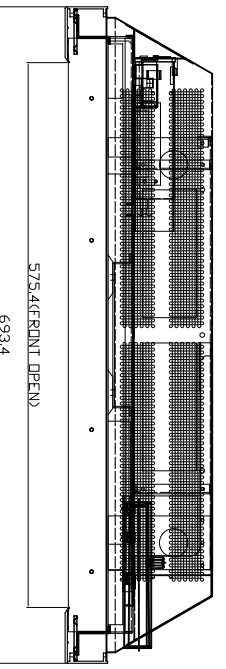
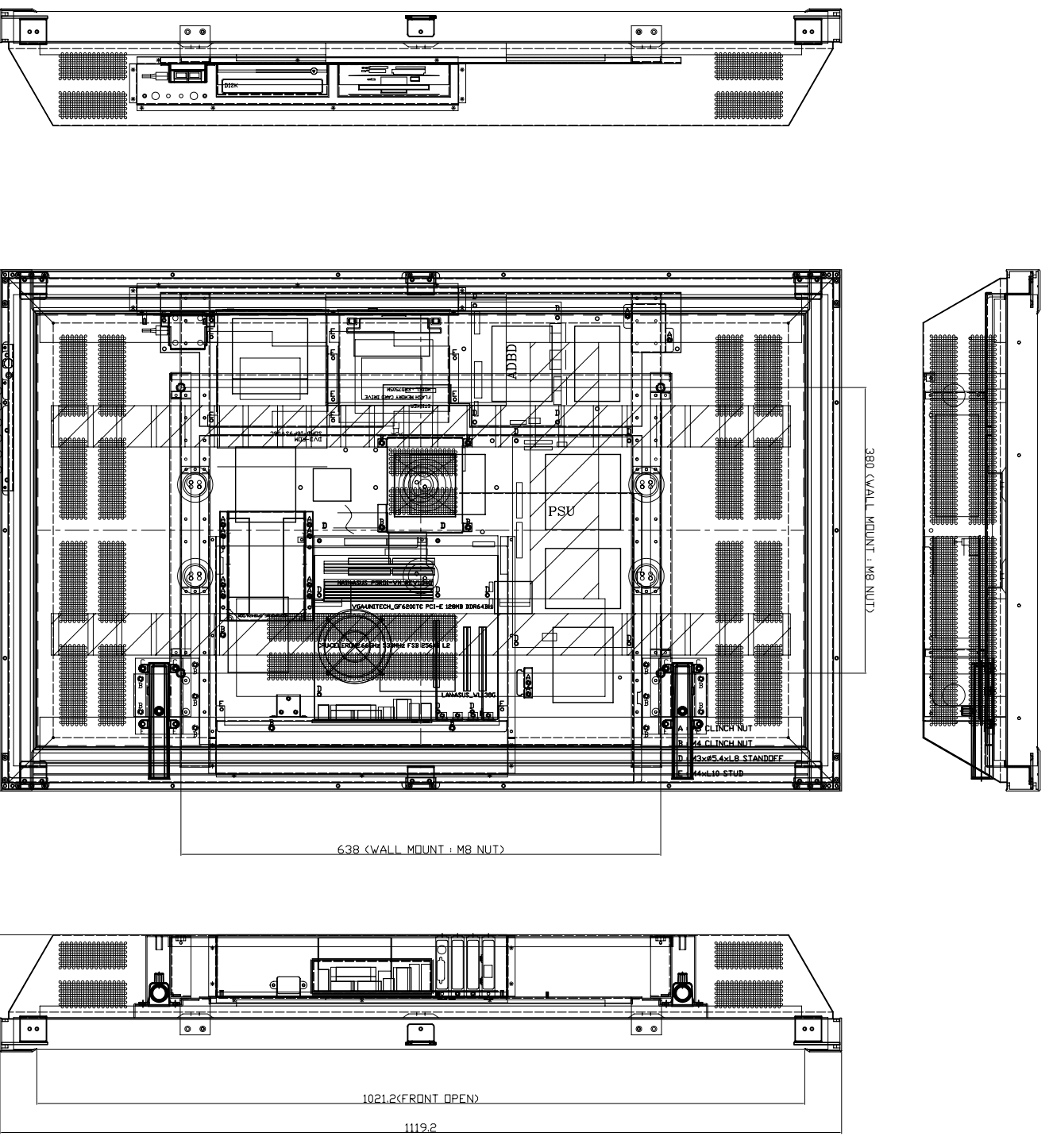

NOTE
 1. Remove all sharp edges
 2. No harmful on the surface

THIRD ANGLE PROJECTION		DIMENSION TOLERANCES		HOLE DIAMETERS	
LENGTH	±0.1	UNDER 3.81	±0.13	UNDER 3.81	±0.13
5.0 ~ 20.9	±0.15	3.81 ~ 6.35	±0.13	6.36 ~ 12.70	±0.13
21.0 ~ 50.9	±0.2	12.70 OVER	±0.25	12.70 OVER	±0.25
51.0 ~ 200.9	±0.4	ANGLE	±0.3°		
201.0 ~ 500.0	±0.6				
500.0 OVER	±1.0				

NO.	DESCRIPTION	Q'TY	DWG NO. (ERP NO.)	REMARK
30	LENS-LARGE	1	93+054201002	-
29	LENS-SMALL	3	93+054201001	-
28	BUTTON-RESET	1	93-094010102	-
27	BUTTON-POWER	1	93-094010101	-
26	BK GUIDE STAND	2	64-342010400	-
25	BK SSD	1	63-200010302	Option
24	BK PCB(PC) COVER	1	63-200010301	-
23	BK DRIVE BLANK	1	63-200010209	-
22	BK USB-PCB	1	63-200010208	-
21	BK DRIVE	1	63-200010207	-
20	BK POWER	1	63-200010206	-
19	BK HDD	1	63-200010205	-
18	BK OTS-CTL	1	63-200010204	-
17	BK BUTTON	1	63-200010203	-
16	BK CD	2	63-200010105	-
15	BK CABLE-B	1	63-200010104	-
14	BK VGA CD-A	1	63-200010102	-
13	BK LAN CD	1	63-200010101	-
12	GUIDE-FRONTM	2	63-246010103	-
11	GUIDE-FRONT R	2	63-240010304	-
10	GUIDE-FRONT L	2	63-240010303	-
9	GUIDE-OSD	1	63-240010302	-
8	BK-STAND	1	63-246012107	L/R
7	BK-BASE ASSY	1	63-246012106	-
6	BK-COVER ASSY	1	63-246012303	-
5	BK-PANEL_M	2	63-246012302	-
4	BK-PANEL	4	63-246012301	-
3	FRONT_R	1	64-246012103	-
2	FRONT_LIR	1	64-246012102	-
1	FRONT_TOP/BOTTOM	2	64-246012101	-