

Instruction OPT-BB-INST-3 Bill-to-Bill Currency Management System

SECURITY LOCKS INSTALLATION

Lock Installation in the Housing:

Step #1. Remove the screw and lock washer from the lock cover.

DO NOT DISCARD! (Please see FIG. 1.)

Step #2. Remove and discard the washer and spacer (Fig. 1).

Step #3. Install the lock and parts, as shown in Fig. 2.

Step #4. Install the cover, screw and lock washer that were removed in Step #1 (please see Fig.3)

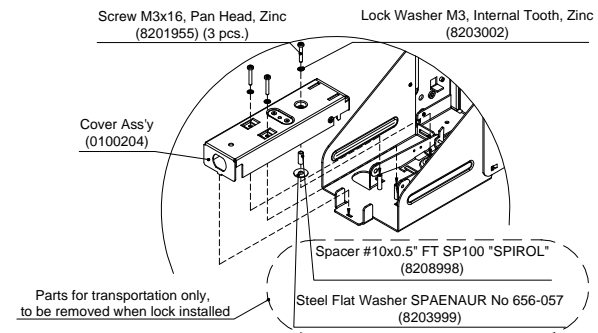

FIG. 1

Variant 1

Mounting kit
OPT-MKFL-FLH1,
that includes :
Cam 5110049-01,
Washer 5110035 is
enclosed.

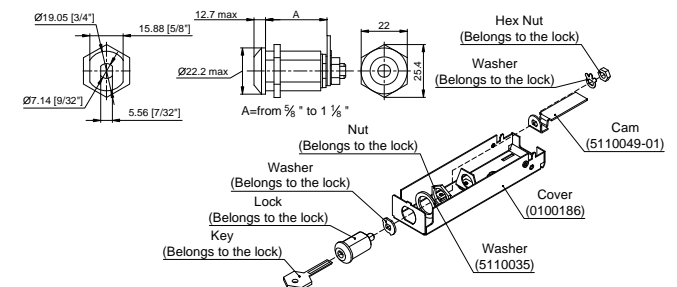
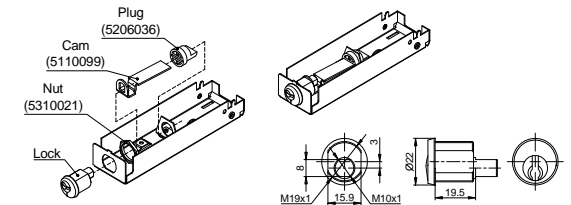

FIG. 2

Variant 2

Mounting kit
OPT-MKFL-FLH2,
that includes :
Cam 5110099;
Nut 5310021;
Plug 5206036,
should be ordered



separately.

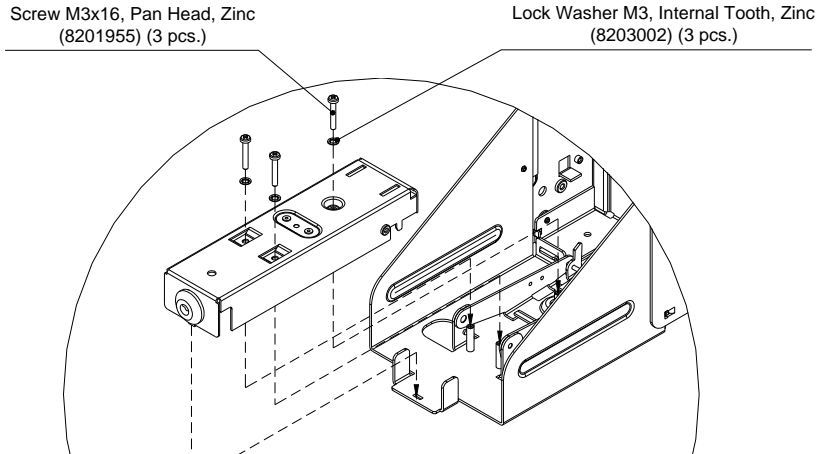

FIG. 3

Lock Installation in Chassis:

- Step #1. Remove the chassis from the housing
- Step #2. Remove the dispensing cassette from the chassis
- Step #3. Unscrew two screws and remove the lock bracket from the dispensing cassette (Fig. 5)
- Step #4. Install the lock into the lock bracket (Fig. 6)
- Step #5. Install the lock bracket into the dispensing cassette (Fig. 7)
- Step #6. Install the dispensing cassette into the chassis
- Step #7. Install the chassis into the housing

Variant 1

Mounting kit
OPT-MK-BBD,
that includes :
Cam 5106018 ,
Washer 5110034-01
is enclosed

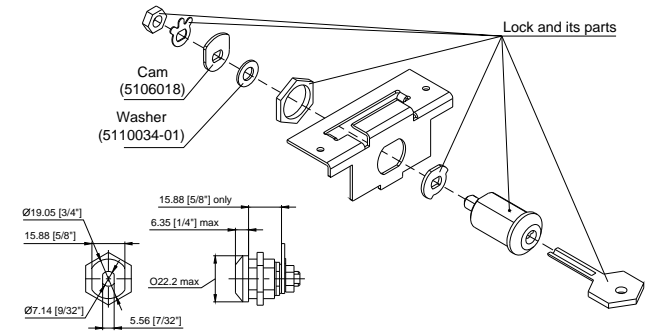

Variant 2

Mounting kit
OPT-MK-BBD1,
that includes :
Lock Washer 8203012;
Cam 5106033-01;
Nut 5310021;
Washer 5310022,
should be ordered
separately.

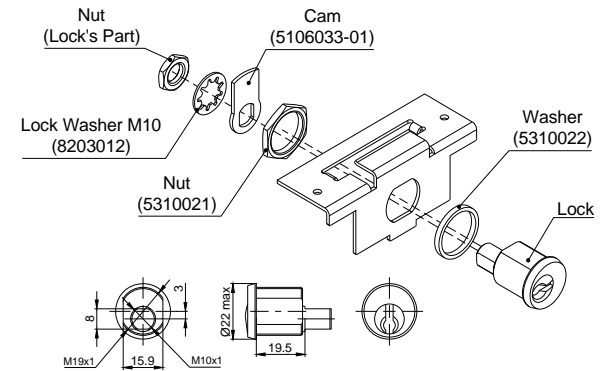

Fig. 6

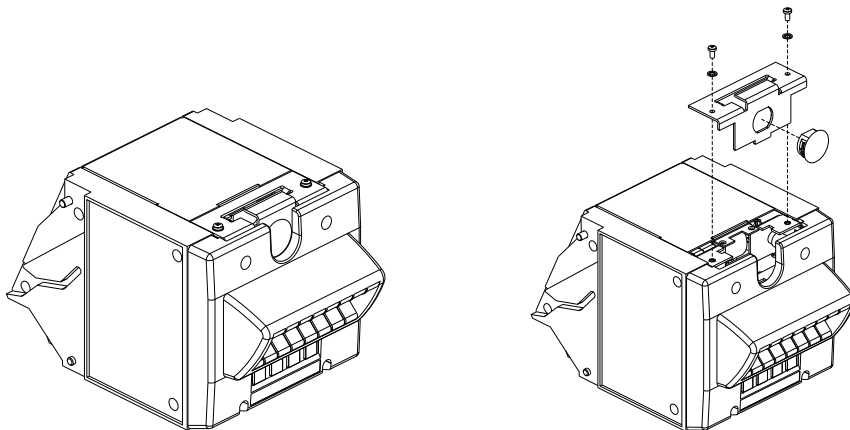

Fig. 4

Fig. 5

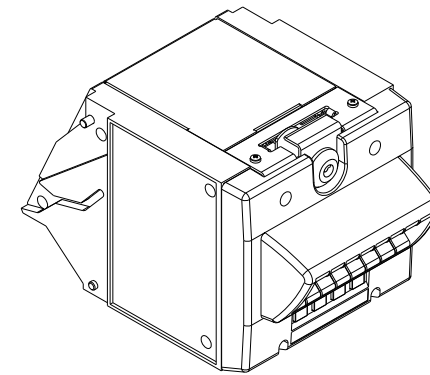

Fig. 7